

# Manual UN/LOCODE Pilot Website

<http://esriurl.com/unlocode>

# Menu Bar

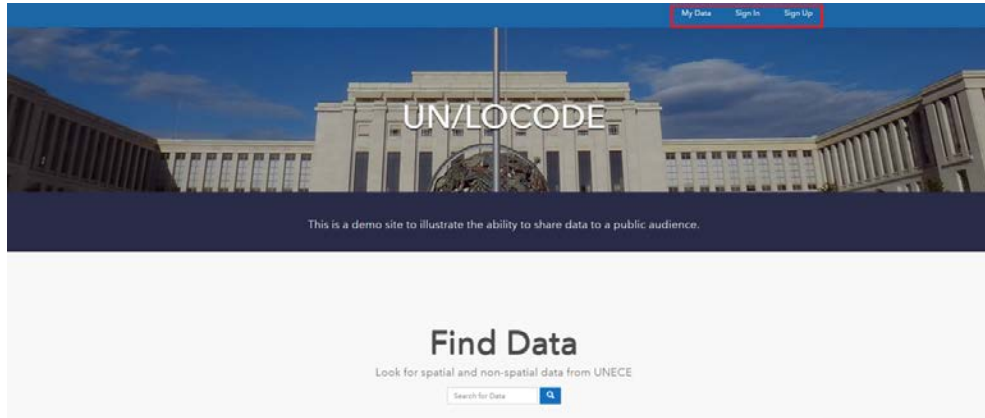

- Please ignore the menu bar at the top of the page
- Scroll down the page to the section 'Applications'
- Pay attention to two applications indicated in the red box

## Applications

This is just a sample section for where you can showcase some of your apps. The 1st and 3rd apps in the tray link to the demonstration apps we have created.



UNLOCODE Viewer Application



Tell stories about local issues and solutions.

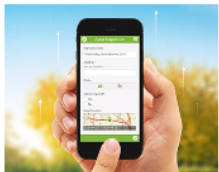

Data Maintenance Request Application



Make your data discoverable, explorable and usable.

[Explore More Apps](#)

# The UN/LOCODE Viewer Application

Click UN/LOCODE Viewer Application

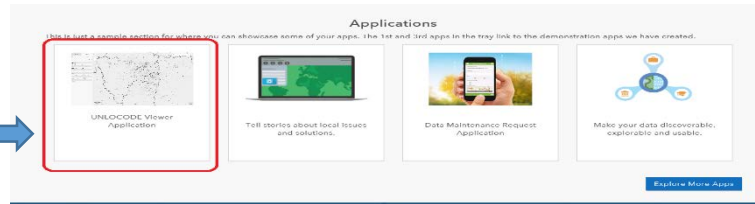

Click Viewer

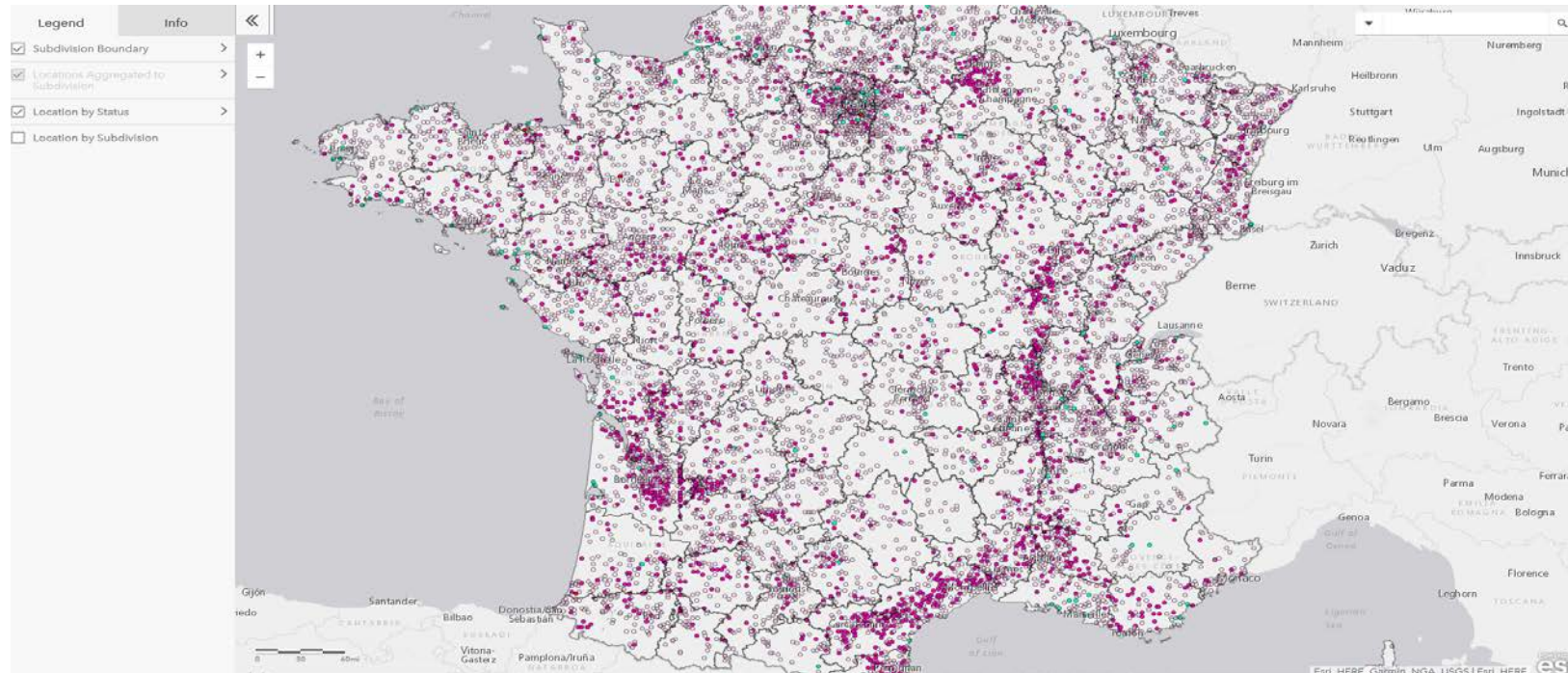
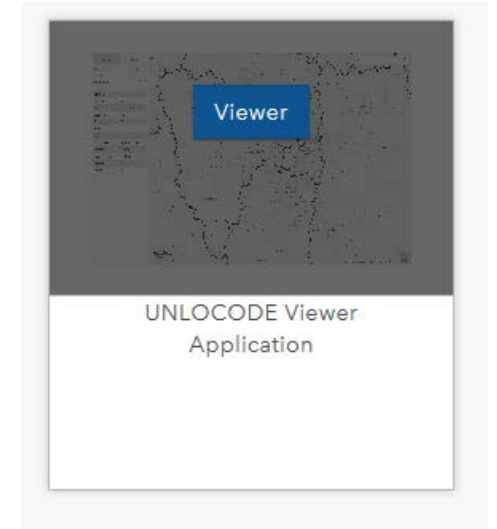

# The UN/LOCODE Viewer Application

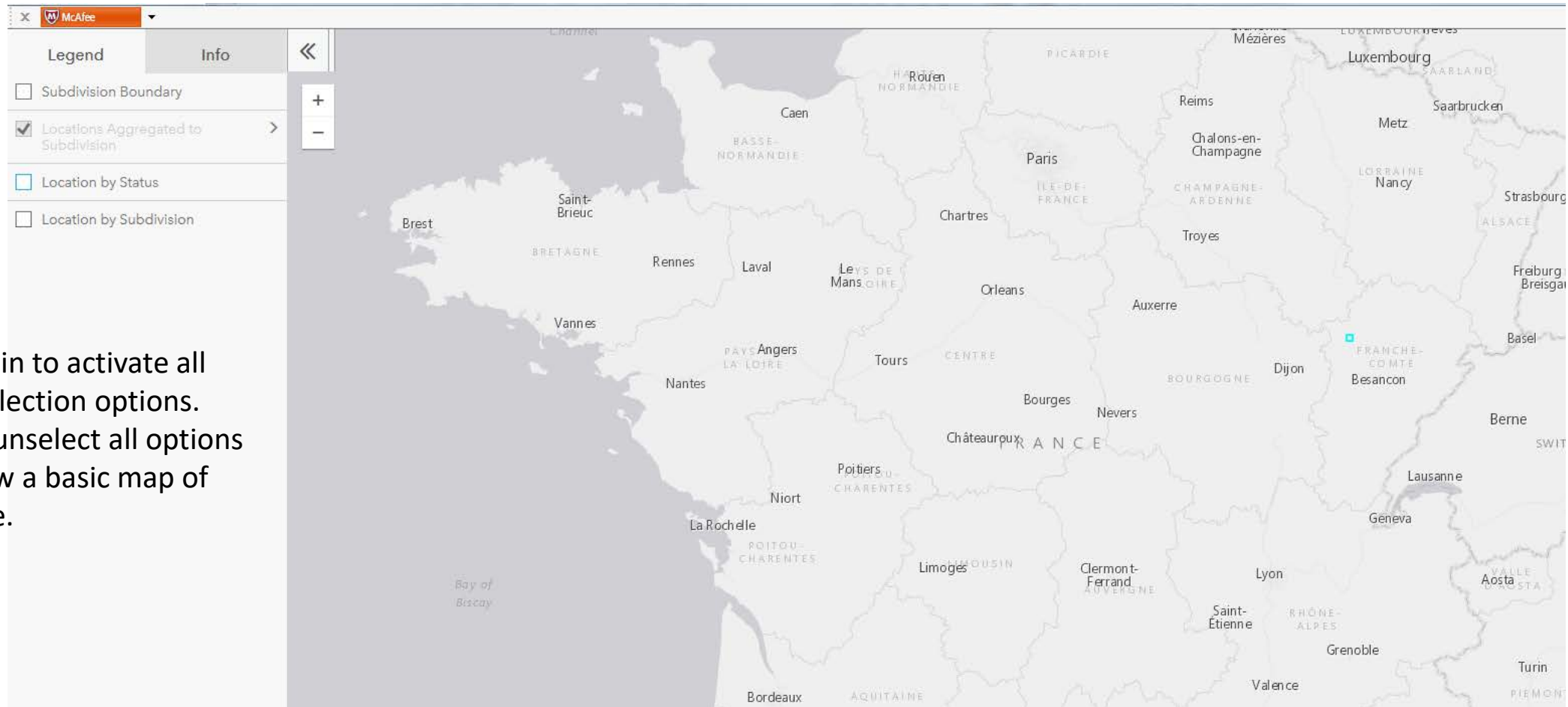

Zoom in to activate all the selection options. Then unselect all options to view a basic map of France.

# The UN/LOCODE Viewer Application



Select 'Subdivision Boundary' to view map with subdivisions

# The UN/LOCODE Viewer Application

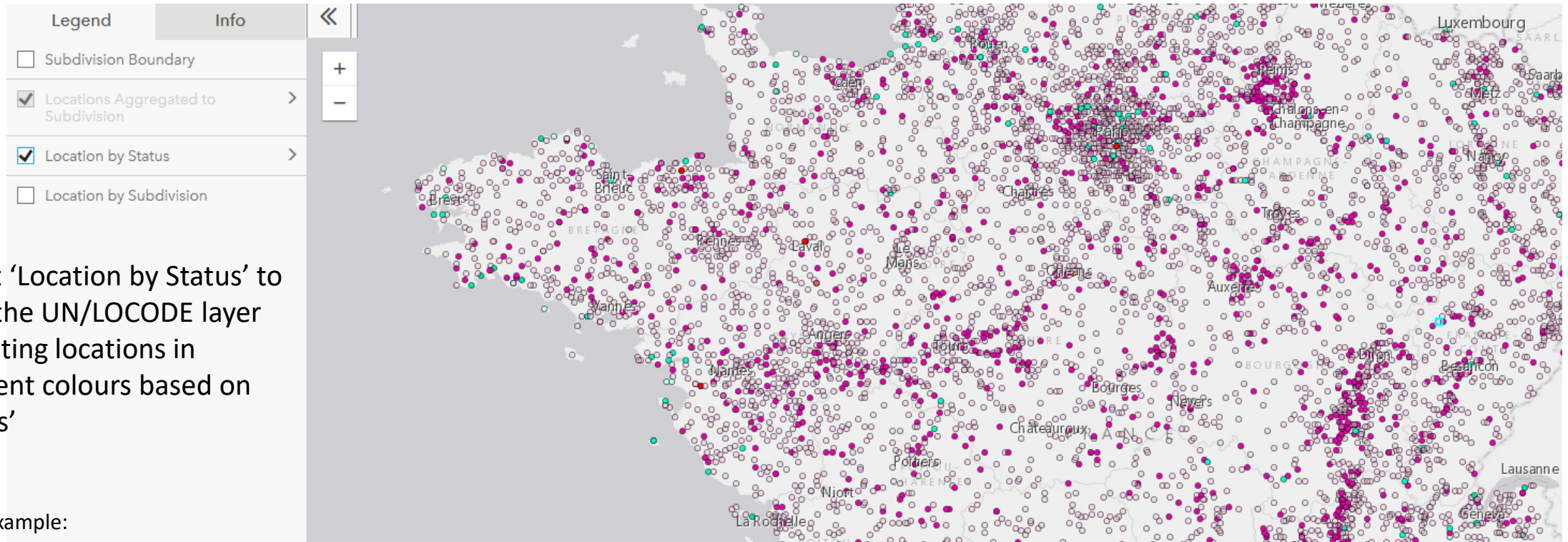

- RQ
- AF
- RL
- AI
- ...

# The UN/LOCODE Viewer Application

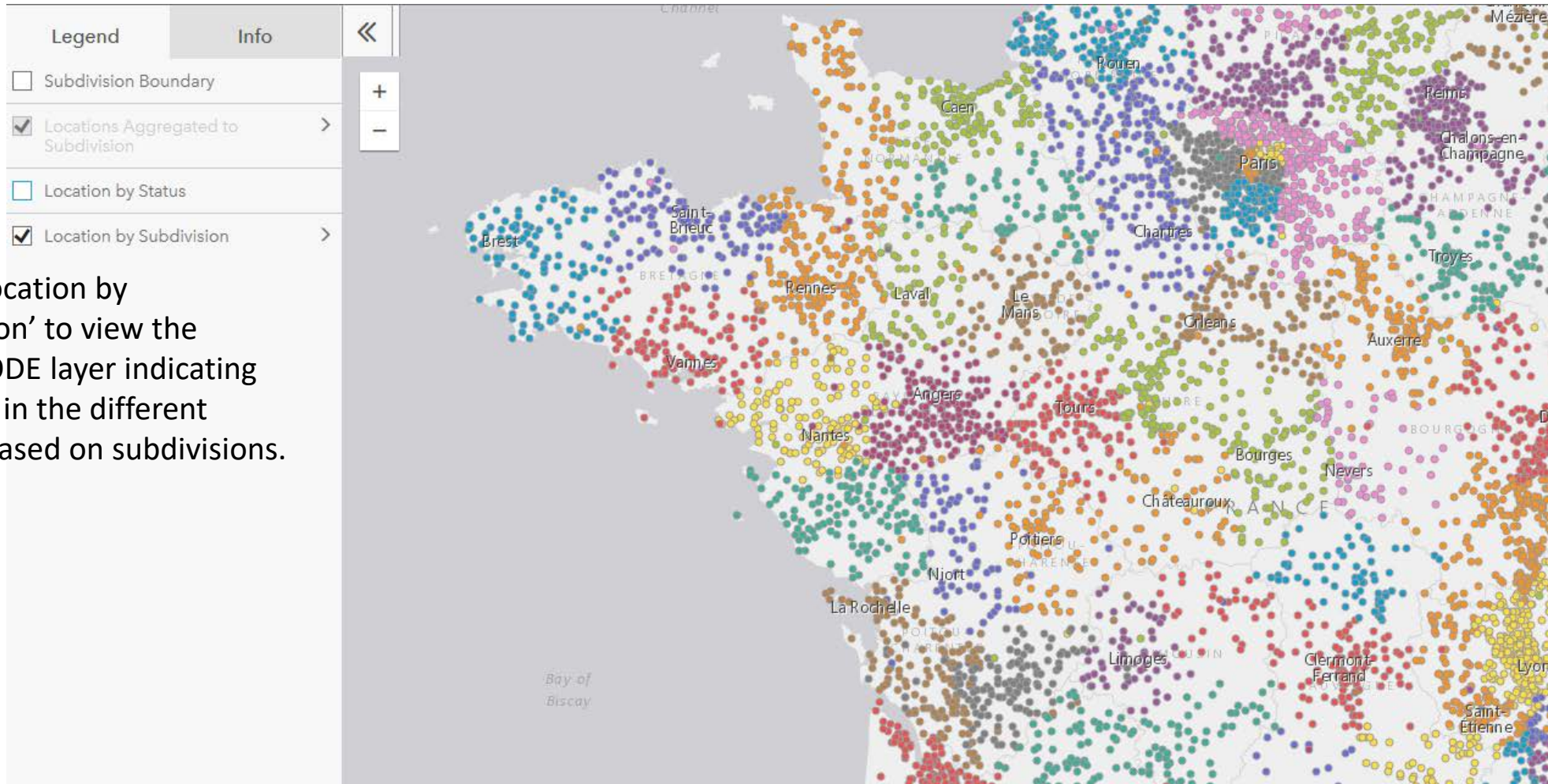

Select 'Location by Subdivision' to view the UN/LOCODE layer indicating locations in the different colours based on subdivisions.

# The UN/LOCODE Viewer Application

Click a coloured point on the map to retrieve and explore the details of the selected location in the tab Info.

Click the arrows <, > to navigate through the different LOCODES at that location. In the example below there are 4.

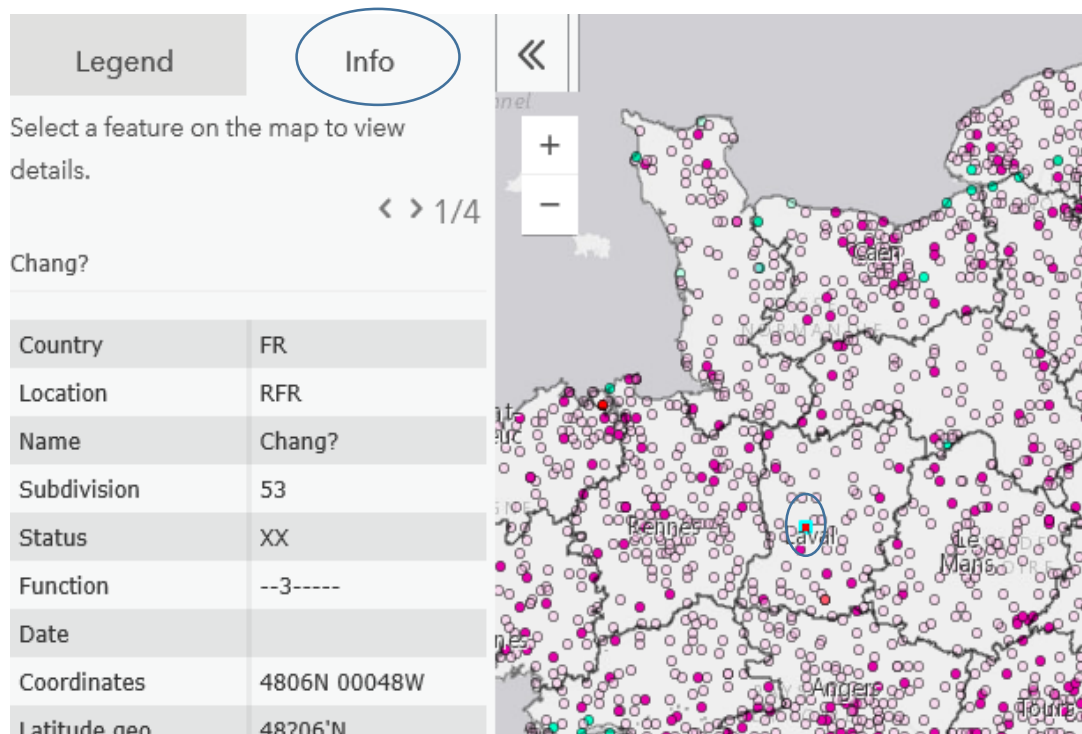

Legend Info

Select a feature on the map to view details.

Chang? < > 1/4

Country	FR
Location	RFR
Name	Chang?
Subdivision	53
Status	XX
Function	--3----
Date	
Coordinates	4806N 00048W
Latitude geo	48.206°N

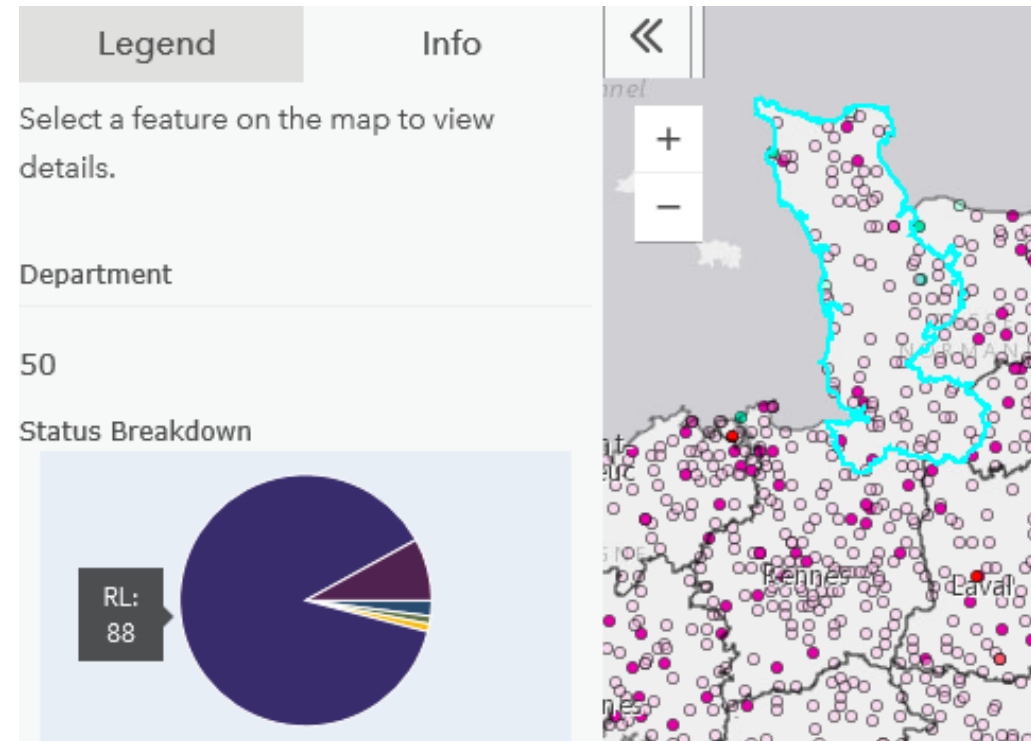

Legend Info

Select a feature on the map to view details.

Department

50

Status Breakdown

RL: 88

Country	FR
Location	RFR
Name	Chang?
Subdivision	53
Status	XX
Function	--3----
Date	
Coordinates	4806N 00048W
Latitude geo	48.206°N



# Data Maintenance Request Application

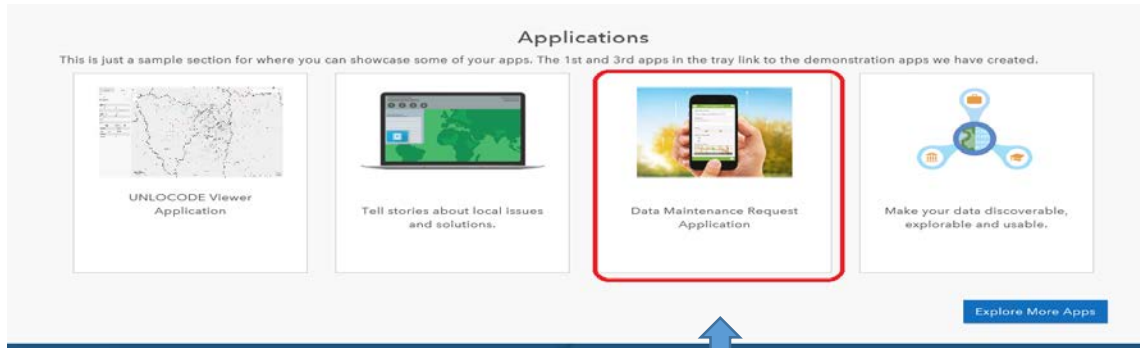

Click to submit an online request for new locations or modifications

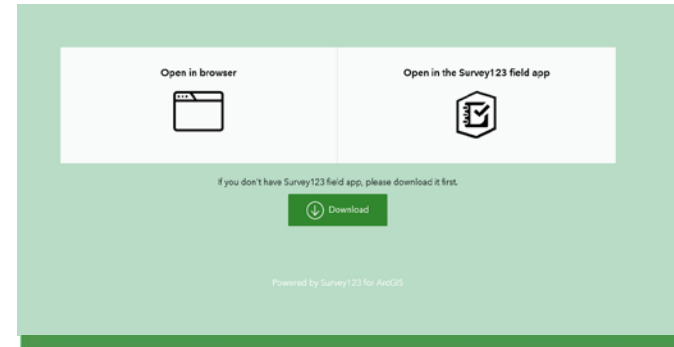

## Step 1

We recommend you to open in browser, otherwise you will need to download the Survey123 field app

**UN/LOCODE - Data Maintenance Request**  
Please submit descriptive and location information for new UN/LOCODE locations, or those in need of an update.

**Name \***  
Please enter your first and last name.

**Email \***  
Please enter your email address.

**Country \***  
Please select a country.  
Please Select

**Location Name**

**Three Character Code \***  
Please enter the desired/existing three character code.  
  
Please input 3 characters

**Function \***  
1 = port (for any kind of waterborne transport)  
2 = rail terminal

## Step 2

Please type in contact information of a requester and location information for a new location, or modification of existing entries.

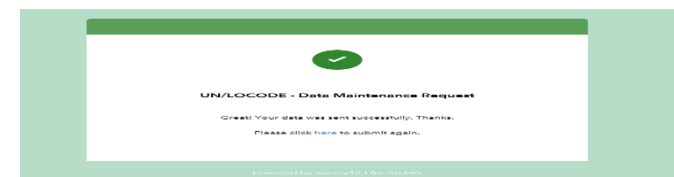

## Step 3

Make sure your data was sent successfully

# Find Data

## Find Data

Look for spatial and non-spatial data from UNECE



If result can be found

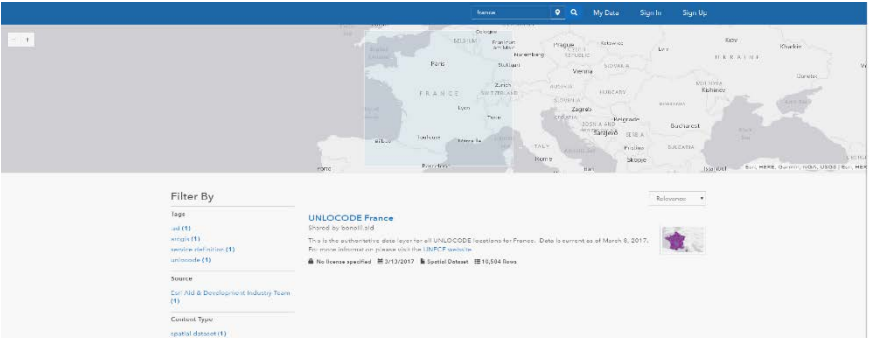

If result can NOT be found



No datasets found. Please try different search terms.

[Browse All Datasets](#)

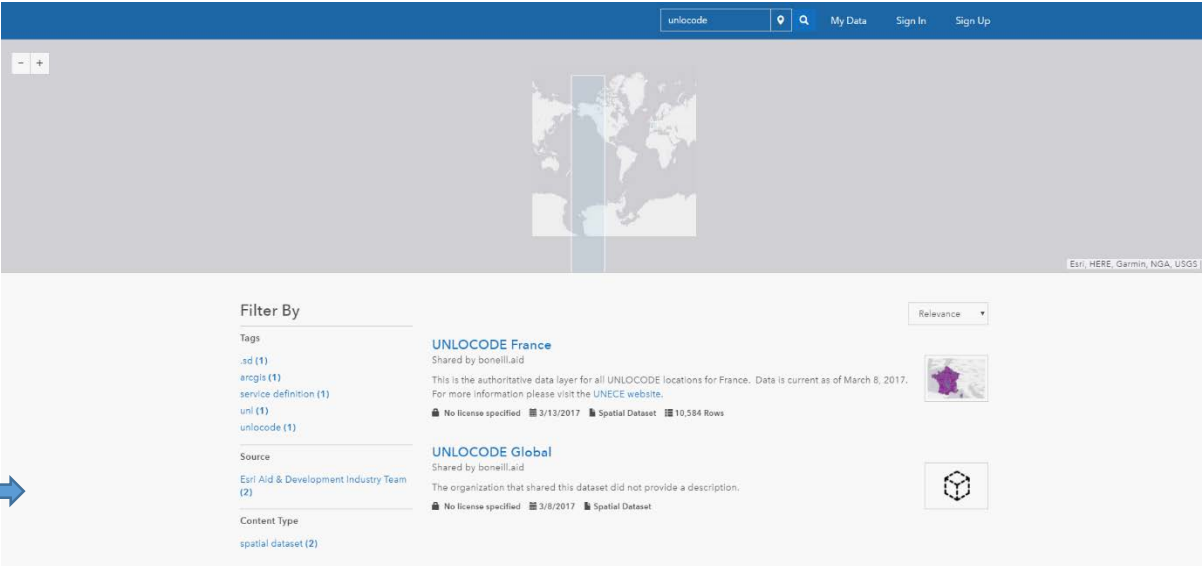
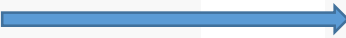

There are two data layers available in the portal at this point, 'UNLOCODE Global' and 'UNLOCODE France'. You can search for 'UNLOCODE', 'France' or 'global'. For now, these are the only inputs that will return values.

# Most popular categories

Configure these buttons for users to jump to most popular categories



UN/LOCODE (for example)



Boundaries



Business



Community Safety



The functions behind these buttons are not relevant to the pilot application of UN/LOCODE. So please ignore for now.



Education



Health



Housing



Transportation